

Press the **[CTRL]** and **[P]** keys,
to print this file with overall floor plan, seating details and dimensions.

Our party and conference rooms

Room	qm	Length	Width	Height	Rows	Parliam.	U-Shaped	Block	Banquet	Euro/Day
Festsaal	190	17m	12(8)m	2,90m	150	94	60	60	150	800,-
Atrium	60	12m	5m	2,90m	50	30	26	26	42	400,-
Festsaal & Atrium	250				200	120	86	86	190	1200,-
Colonnaden I	90	11m	8m	2,90m	90	50	34	34	72	500,-
Colonnaden II	65	10(6)m	8m	2,90m	50	30	20	20	56	400,-
Colonnaden I & II	155				140	80	56	56	140	900,-
Hamburg	70	12m	6m	2,90m	50	30	26	26	42	400,-
Alster	45	8(4)m	8m	2,60m	30	24	18	18	30	300,-
Elbe	55	6m	9m	2,60m	36	24	18	18	42	400,-
Alster & Elbe	100				66	48	36	36	72	700,-
Esplanade & Lounge	75	9m	5(3,3)m	2,90m	30	24	18	20	30	400,-

Floor plan Hotel Eggers

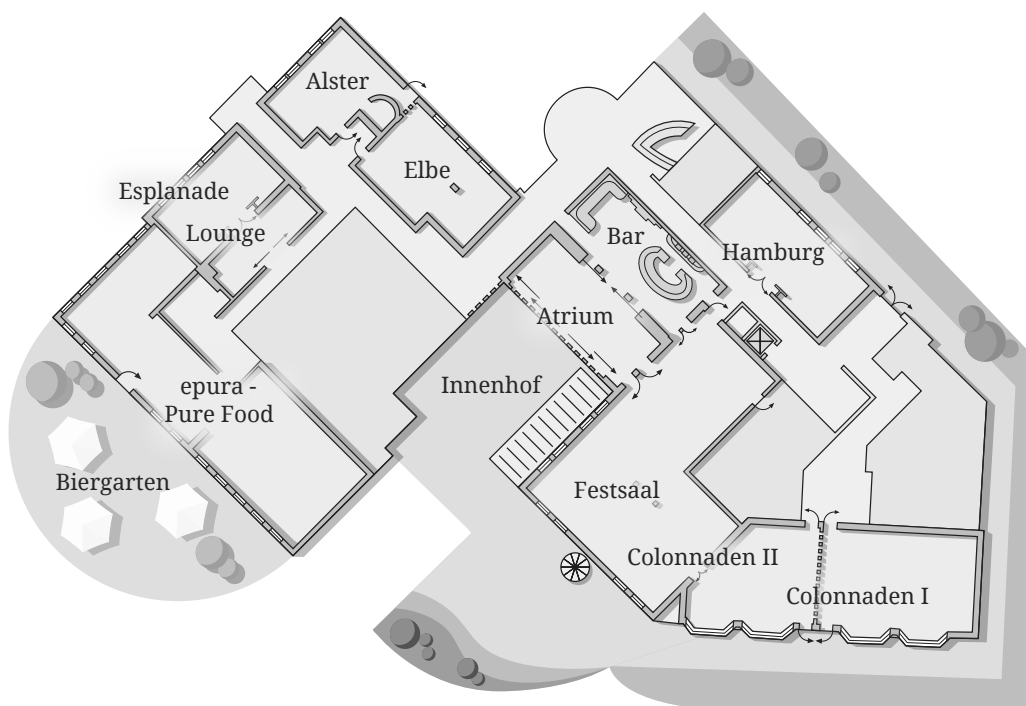

Hotel Eggers Hamburg

Rahlstedter Straße 78 · 22149 Hamburg · Tel. (040) 675 78 - 0 · Fax (040) 675 78 - 444